

# INTRICATE | *Complex Details*



When all you really want is a family sanctuary with an upper level just for the kids, an Intricate home is a great choice. One third of the main level design is devoted to the time families spend in the kitchen, complete with a walk in pantry and three dining areas. Furthermore, a large bar counter is nestled conveniently into the sunken great room for those Monday Night Football games. And dads can rest easy if the dinner menu calls for grilling, the HDTV can be seen from the kitchen and the deck.

Client Wants: To design a home on a severe slope that fits around a quaint cove on the lake, capturing the view from the living area with ease, and allowing for intimate spaces within the home's expanse.



13526 Hwy 55  
McCall, ID 83638  
ph#: (208) 634-0055

6254 E. Parks Rd (PO Box 509)  
Athol, Idaho, 83801  
ph#: 208-683-1444  
fax: 208-683-0549

brian@edgewoodlog.com  
www.edgewoodlog.com

# INTRICATE | *Complex Details*

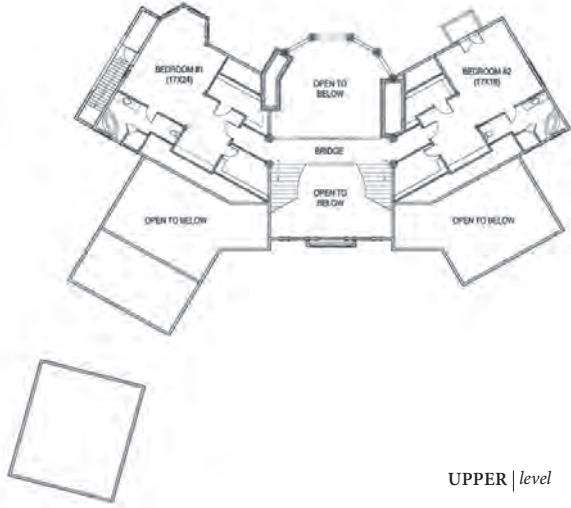

UPPER | level

**Square Footage:** 6900 (11,300 with Lower Level)

**Location:** Coeur d'Alene, Idaho

**Bedrooms / Baths:** 3/5 ( 4/8 with Lower Level)

**Built:** 2006

**Type of Package:** Custom Design, Log & Timber Accent Package

**Package Details:** Handcrafted Western Larch Elements

**Special Features:** Glass Forest, Custom Trusses, Porte Cochere

**Time to Contract:** 28 Months

**Package Price:** \$890,000

**Estimated Turn-Key:** \$5,000,000



MAIN | level

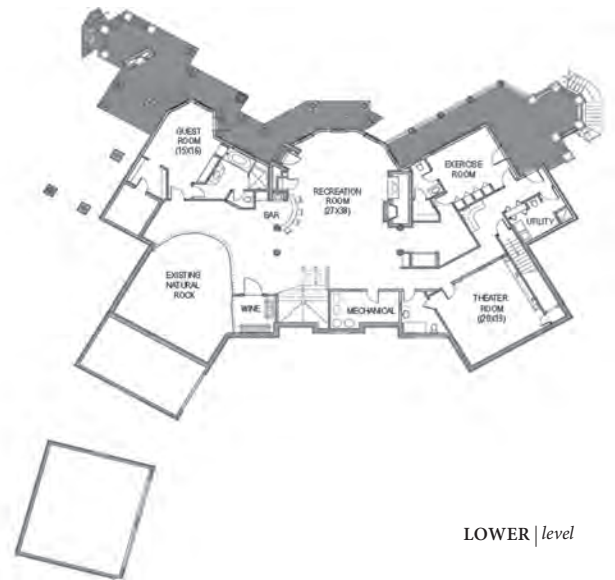

LOWER | level



13526 Hwy 55  
McCall, ID 83638  
ph#: (208) 634-0055

6254 E. Parks Rd (PO Box 509)  
Athol, Idaho, 83801  
ph#: 208-683-1444  
fax: 208-683-0549

brian@edgewoodlog.com  
www.edgewoodlog.com